

Rural Nursery Prototype and Estimated costs

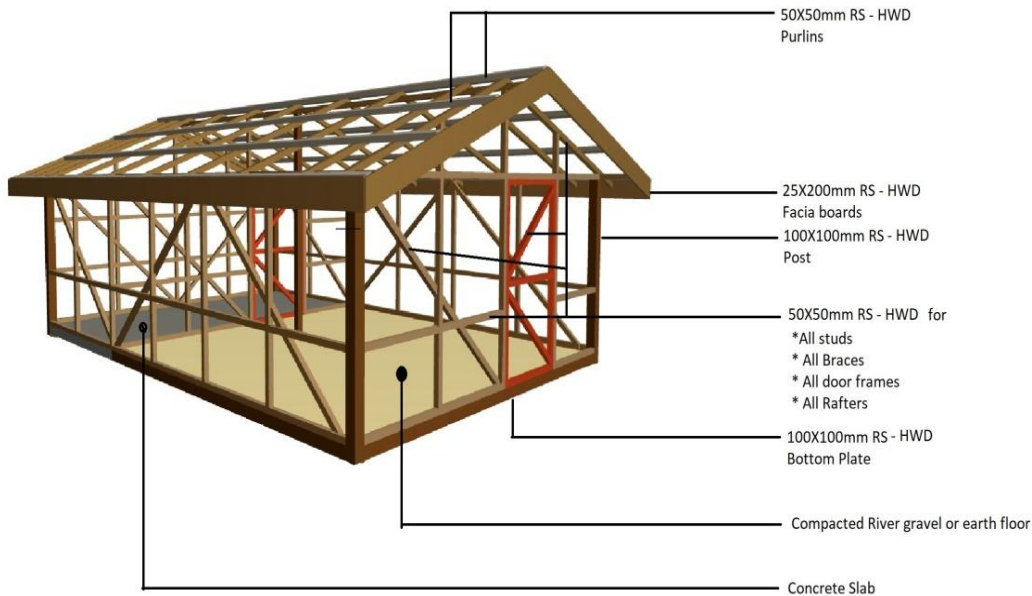

		AMOUNT
1	ROUGH SAWN TIMBER	1,359.20
2	ROOFING	4,102.59
3	CONCRETE & AGGREGATES	193.44
4	WATER TANK CONNECTION	1,122.27
	TOTAL MATERIAL COSTS	6,777.50
4	FREIGHT @ 50%	
	SUB TOTAL (including GST)	6,777.50
	Labour	
	GRAND TOTAL	6,777.50